

# THE PIGEON POST

The Newsletter of Loncon 3  
Issue 0: Wednesday  
newsletter@loncon3.org

@Loncon3



## HELLO FROM THEM...

This isn't the real welcome, that's still being unpacked and assembled!

For today, we just want to say thank you to everyone who is giving up their time to help us get everything ready for tomorrow, so that we can make this a great Worldcon.

— Steve and Alice

## HOW TO HELP

If you're in the lucky position of having enough time to sit down and read this newsletter, you probably haven't got enough to do! If that's the case and you'd like to help get everything ready for the convention, please head along to the volunteer desk, by Registration on level 0 of the Boulevard, to see if they can find you a job to do.

Don't be put off if you aren't able to lift and carry, or if you need a job where you can sit down: there is plenty to do, and there's sure to be something that fits your skills.

## VOLUNTEER REWARDS

Even though you'd all help out anyway, from the goodness of your hearts, we may as well let you know what rewards are on offer!

You'll get a Groat for each hour worked for the convention. They are worth £1 and can be used at the food and drink outlets in the Fan Village, and with most of the dealers in the Dealers' Zone.

You can pick up your timesheet from Volunteers, and return it

there when it's full. Time should be signed off by a Division or Area Head or, if that's not practical, by whoever was in charge of the work you were doing.

If your timesheets total more than fifteen hours worked, you can claim your t-shirt from Volunteers. Hours worked before 10am on Thursday count double! There will also be a daily raffle for volunteers.

Once it's been set up, all volunteers will have access to the Staff Lounge in the Fan Village. There, you'll find a nice cozy space to relax, with comfy seating, some refreshments, and power outlets for charging. If you bring earplugs and an eye mask you could probably grab a refreshing power nap as well!

## GENERAL MIMO GUIDELINES

We're sure that you are all sensible people who don't need to be reminded, but here are a few things to keep in mind during MIMO.

ExCeL staff will be wearing yellow hi-vis. Our own decision makers will be wearing red: listen to these people when they tell you to do, or not do, something!

Everyone who is working on MIMO should attend one of ExCeL's briefing sessions: if you haven't already done so, please go to the one at 2pm today.

In an emergency, speak to a member of ExCeL staff or dial 4444 from an internal phone:

ExCeL's team will get to you as quickly as possible, and direct the emergency services if required.

Please be sensible when lifting and carrying: bend from the knees, don't try to do or carry too much at once, and don't try to rush: better safe than fast.

Remember to take regular breaks for a sit down, a drink and a bite to eat: don't forget your meals.

Be particularly careful if you're working in an area where power tools are in use, or where work is being carried out on the electrical systems.

## POSTERS AND THINGS

We can use white-tack to attach posters and fliers to surfaces that won't be damaged (so not painted / plastered surfaces, but wood, glass or concrete are fine) in the spaces that we've booked, like the Capital Hall and Capital Suite, but not in public areas like the Boulevard and lifts.

## PUB TONIGHT

If you want to get together for a drink this evening, please head over to La Barrique, by the west entrance to ExCeL, from 8pm (there's another function in the space before that).

As a thank you for your hard work, the convention is laying on some fairly robust nibbles and pizzas for you to refuel on. To show that you did work hard, please keep your MIMO badge on. They won't be serving their regular menu. It's a cash bar, but they do have Meantime on tap.

## GETTING AROUND

We're sure that you'll figure out where everything is eventually. Until then, here's part of Keri O'Brien's great map from the Pocket Programme.

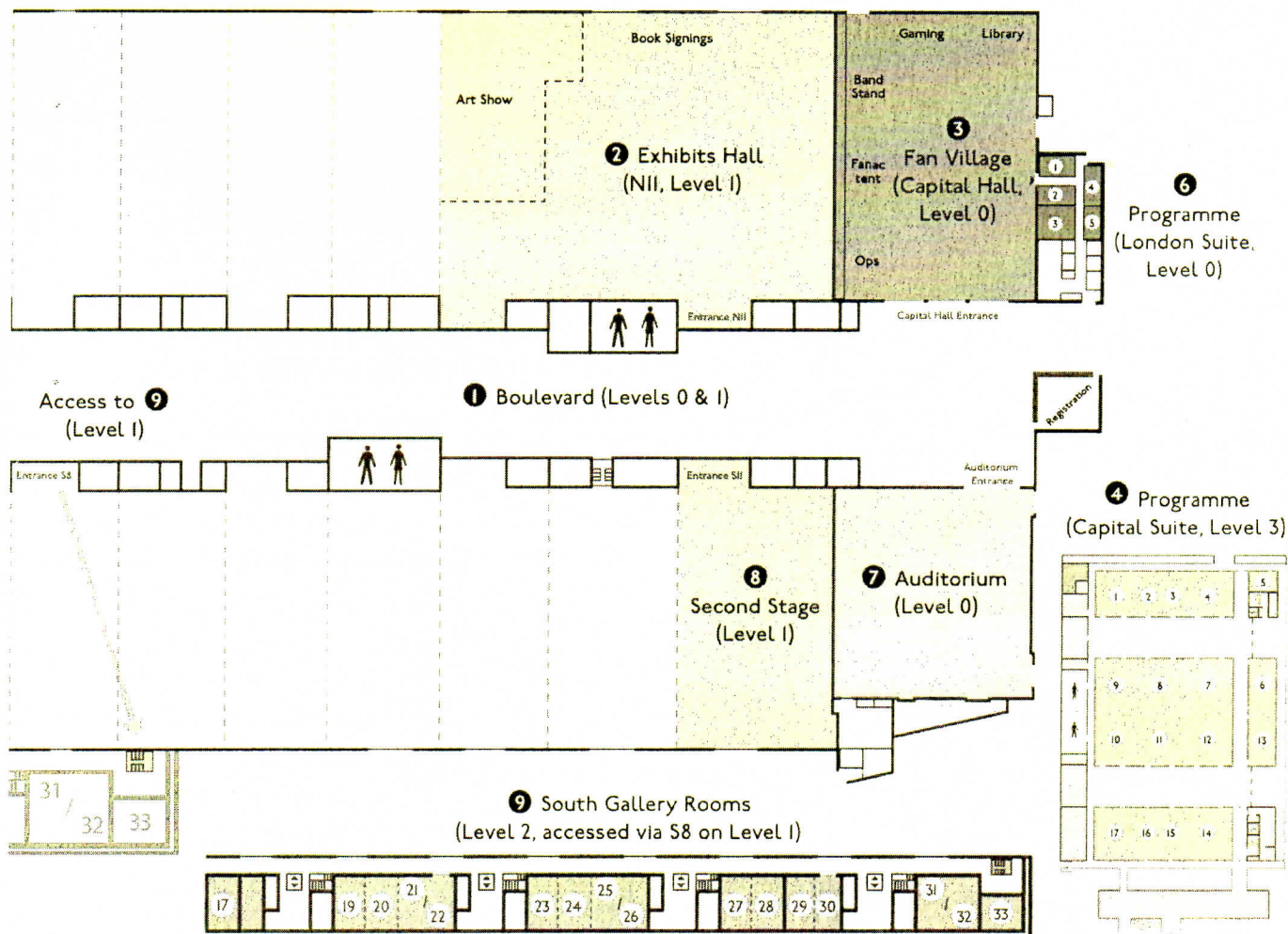

## RESTAURANTS

It's too early for the newsletter team to have received any restaurant reviews [At least, so I thought: one just came in. You're mad, all of you. —Ed], but we thought that you might like a few pointers. We've blatantly nicked these from the Restaurant Guide, because they look cheap, quick and local, but have a look at the other great suggestions in it.

- ♦ Airline Cafe & Diner (hot meals including fryups, open till 10pm) - 14 Western Gateway, Royal Victoria Dock, E16 1FD.
- ♦ Café Bonnane (fryups, sandwiches, jackets, pasta, open till 6pm) - Unit G8, ExCeL Marina, Western Gateway, E16 1DR.

- ♦ Customs Bakery and Sandwich Bar (sandwiches and pasties, open till 4:30pm) - 49 Freemasons Road, Custom House, E16 3PJ.
- ♦ Freemasons Cafe (fryups, sandwiches, jackets, omelettes, open till 3:30pm) - 27 Freemasons Road, Custom House, E16 3AR.
- ♦ Le Royal (curry and kebab takeaway, open till 11pm) - 13 Freemasons Road, Custom House, E16 3AR.
- ♦ Royal Docks Pizza (pizza delivery) - 020 7511 8046

There is a Whistlestop on the ExCeL Boulevard, near the west (far) end of the building. There are Londis and Tesco Express supermarkets on Western Gateway, the road running west

from ExCeL past the Novotel and Crowne Plaza hotels.

There's also a coffee shop at our end of ExCeL, which should be open during all of MIMO.

## LAND GOODBYE FROM US

This is the zeroth issue of Loncon 3's newsletter, and we hope that you'll all stick with us as we move into the positive numbers tomorrow.

You can email the newsletter team on [newsletter@loncon3.org](mailto:newsletter@loncon3.org), and we'll get some submission boxes set up just as soon as we find some boxes that don't still have stuff in them: look for the locations in tomorrow's issue.

This issue was produced by Flick, with help from Jan van't Ent. Masthead by Serena Culfeather. Today is International Lefthanders Day. We hope that the MIMO team has appropriate tools for ten percent of the team.